

# Ming Yang Reels Model CZH 40, 50 and 60

Note: When ordering parts, please add CZH456- to the corresponding part number as identified by diagram.

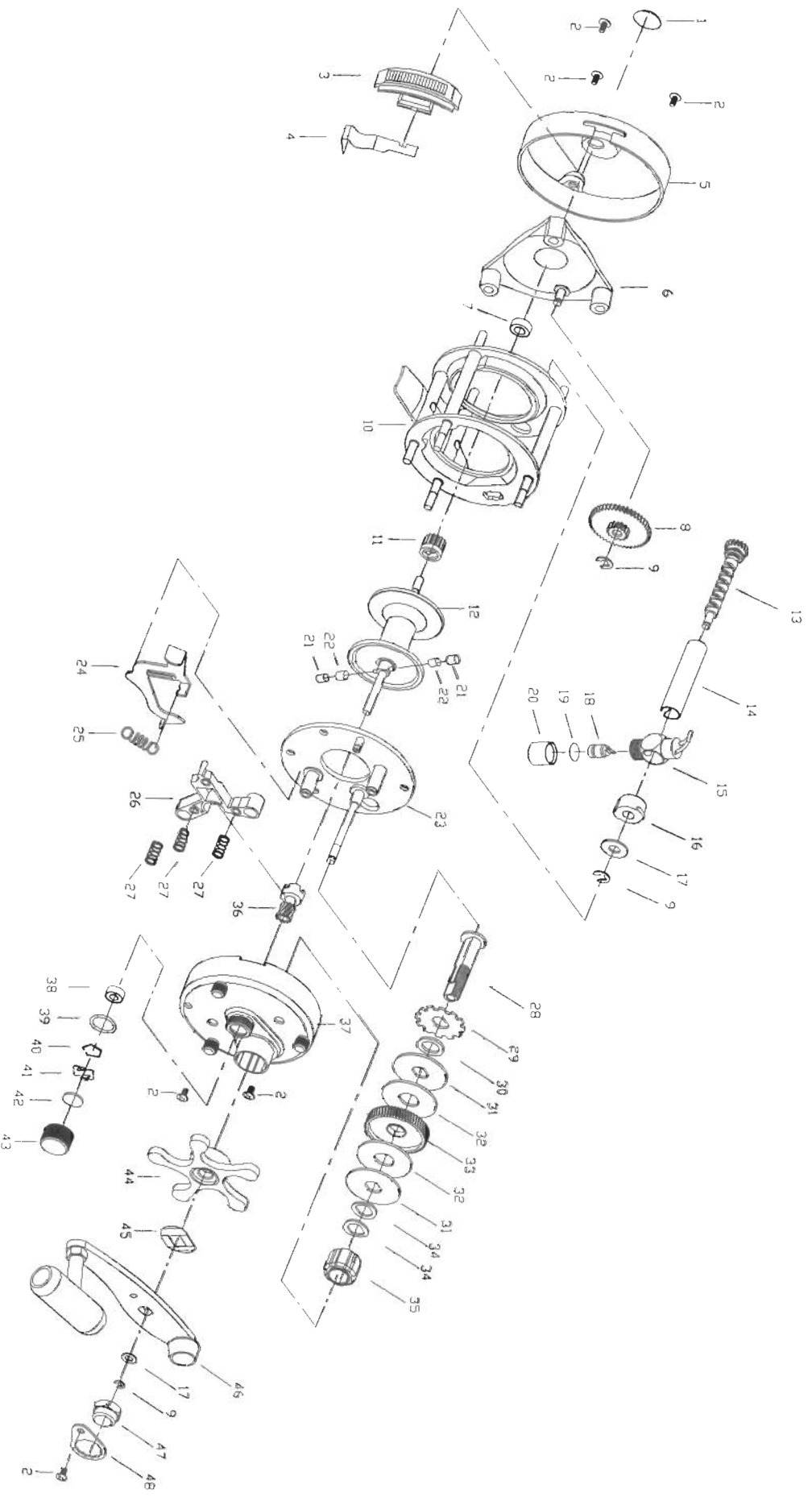

## CZH40 50 60

## Ming Yang Reels Model CZH 40, 50 and 60

Note: When ordering parts, please add CZH456- to the corresponding part number as identified by diagram.

Part No.	Description	Part No.	Description
CZH456-1	Label	CZH456-30	Washer
CZH456-2	Screw	CZH456-31	Washer
CZH456-3	Bait Clicker Button	CZH456-32	Drag Friction Disc
CZH456-4	Washer Bait Clicker Spring	CZH456-33	Main Gear
CZH456-5	Left Side Plate	CZH456-34	Drag Spring Washer
CZH456-6	Left Gear Plate	CZH456-35	Anti-Reverse Ball Bearing
CZH456-7	Washer	CZH456-36	Thumb Button Pinion Gear
CZH456-8	Level Wind Gear	CZH456-37	Right Side Plate
CZH456-9	E-Ring	CZH456-38	Ball Bearing
CZH456-10	Main Body Assembly	CZH456-39	O-Ring
CZH456-11	Level Wind Pinion Gear	CZH456-40	Retaining Clip
CZH456-12	Spool Assembly	CZH456-41	Cast Control Brass Washer
CZH456-13	Worm Shaft	CZH456-42	Cast Control Rubber Washer
CZH456-14	Line Guard	CZH456-43	Cast Control Knob
CZH456-15	Line Guide	CZH456-44	Star Drag Handle
CZH456-16	Bushing	CZH456-45	Handle Spring Washer
CZH456-17	Washer	CZH456-46	Handle
CZH456-18	Line Guide Pawl	CZH456-47	Handle Nut
CZH456-19	Washer	CZH456-48	Latch Keeper
CZH456-20	Line Guide Pawl Cap		
CZH456-21	Friction Brake Shoe		
CZH456-22	Centrifugal Brake Shoe		
CZH456-23	Right Gear Plate		
CZH456-24	Thumb Button		
CZH456-25	Latch Spring		
CZH456-26	Yoke		
CZH456-27	Yoke Spring		
CZH456-28	Crankshaft		
CZH456-29	Clutch Disc		